

Insulated Roof & Wall Panels

Installation Guide



Architectural Wall Panels (AWP)
KS600-1000 CX/EB/FL/FL-S/MR/MM/PL/LW
KS1000 CW/LV/TL
Vertically Laid



Note: Ensure steelwork is suitably lined, levelled and within tolerance. Visually check internal liner joint to ensure panels are joined fully. Check panel cover width module as works progress to ensure "creep" does not occur, particularly important when windows are incorporated into the elevation. Joints need to be aligned correctly during installation to prevent the 'saw tooth' effect at the drip. Fasteners to suit project specification requirements i.e. carbon / stainless steel. Gun-grade sealant referred to are: - non-setting butyl sealant - silicone sealant

Tape sealant referred to is butyl tape sealant. Note: As an alternative to using butyl air sealants, a PVC foam tape (SVG25) can be used for an air seal. Please refer to Technical Update EU87 on Internal Air Seals and consult with our Kingspan Technical Services for further guidance. All sealants to suit project specification requirements. This is a generic AWP installation guide, however details may differ from project to project. Project specific construction details must be used, please contact Kingspan Technical Services for further information. Low air leakage rates can be achieved, for further information contact Kingspan Technical Services

c Apply an unbroken 6mm Ø bead of non-setting gun-grade butyl sealant to provide an air seal between back of panel and closure flashing

b Line, level and fix drip flashing using low profile fasteners. Joints in the drip flashing to incorporate butt straps sealed with two runs of non-setting gun-grade butyl sealant

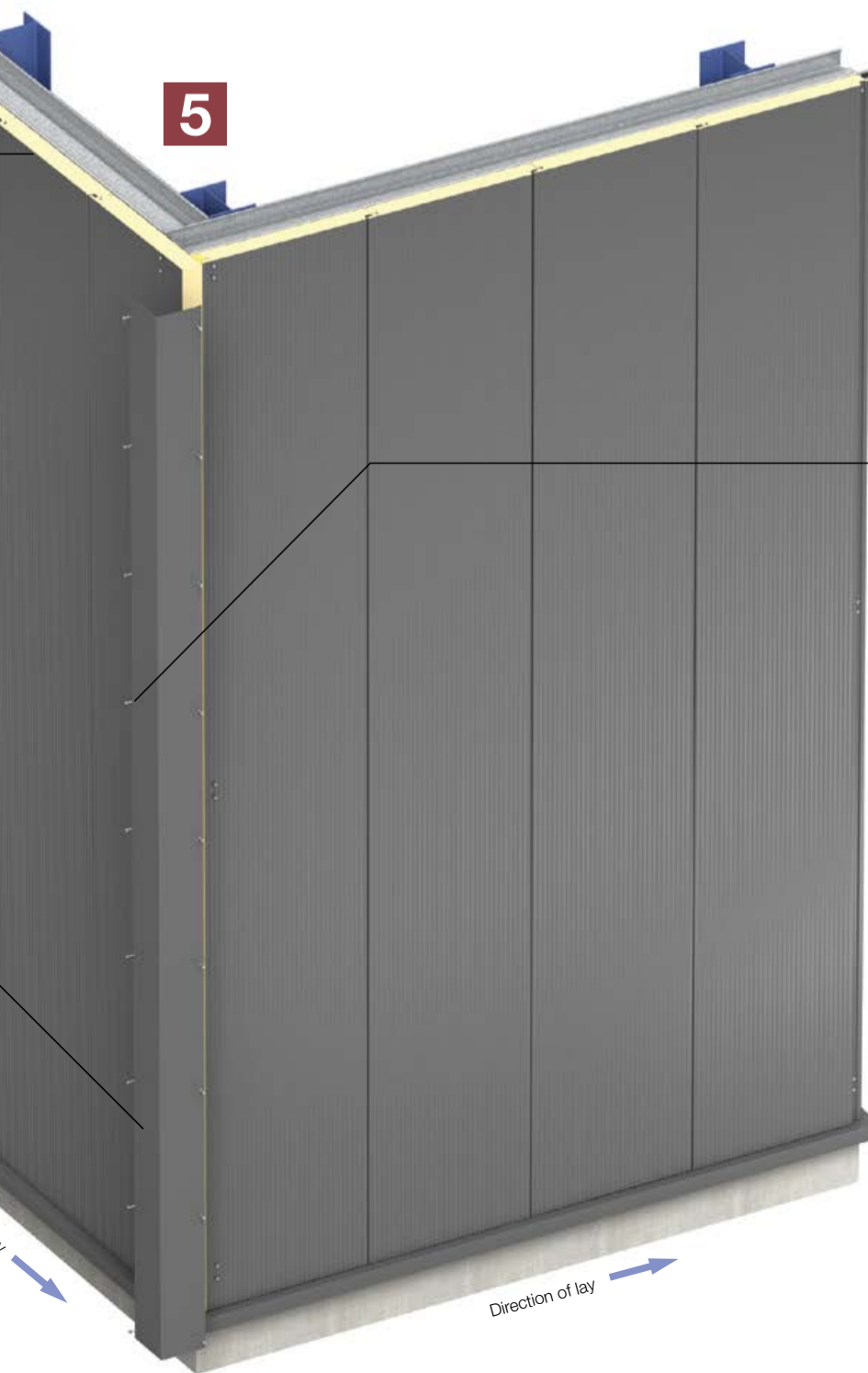
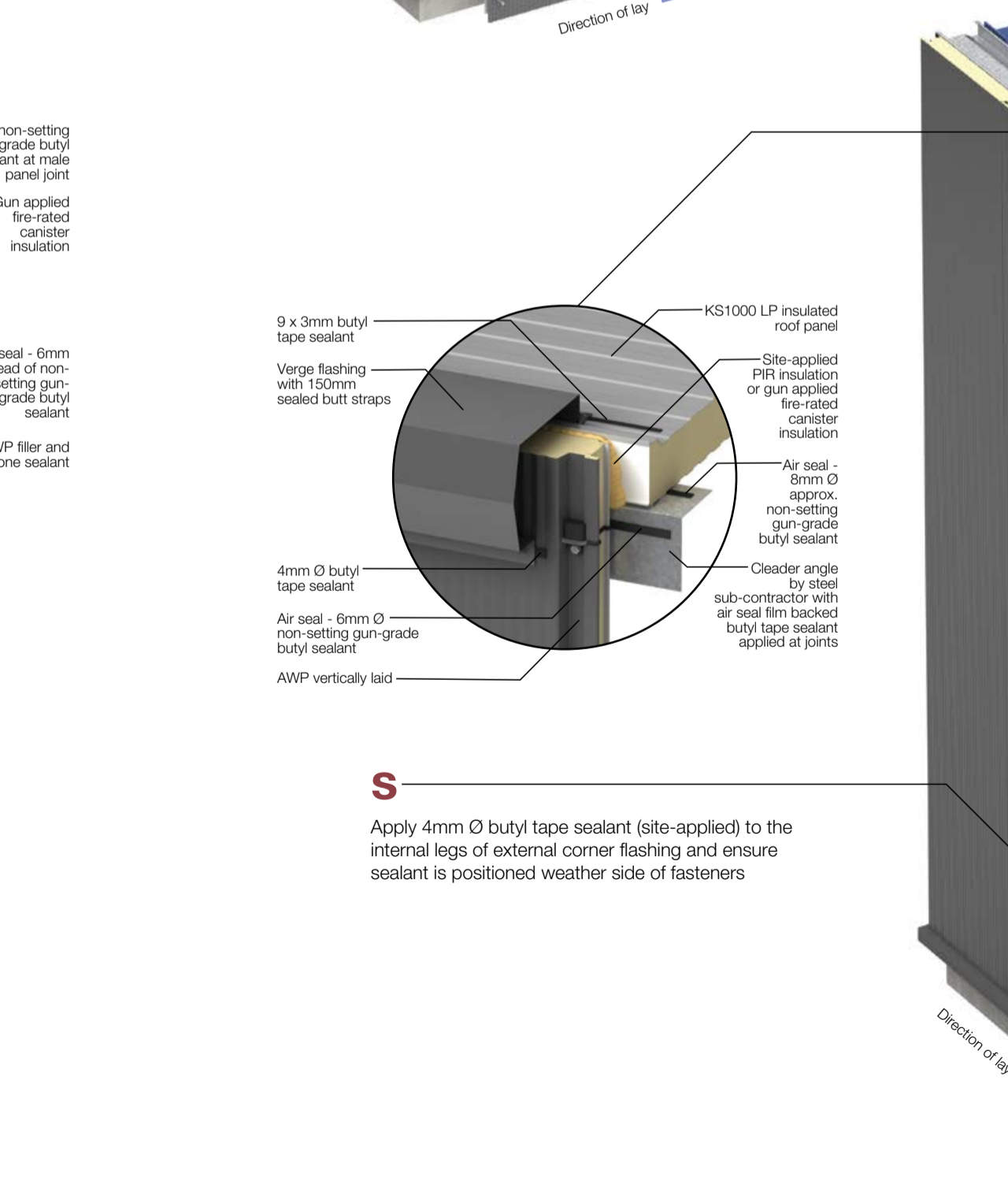
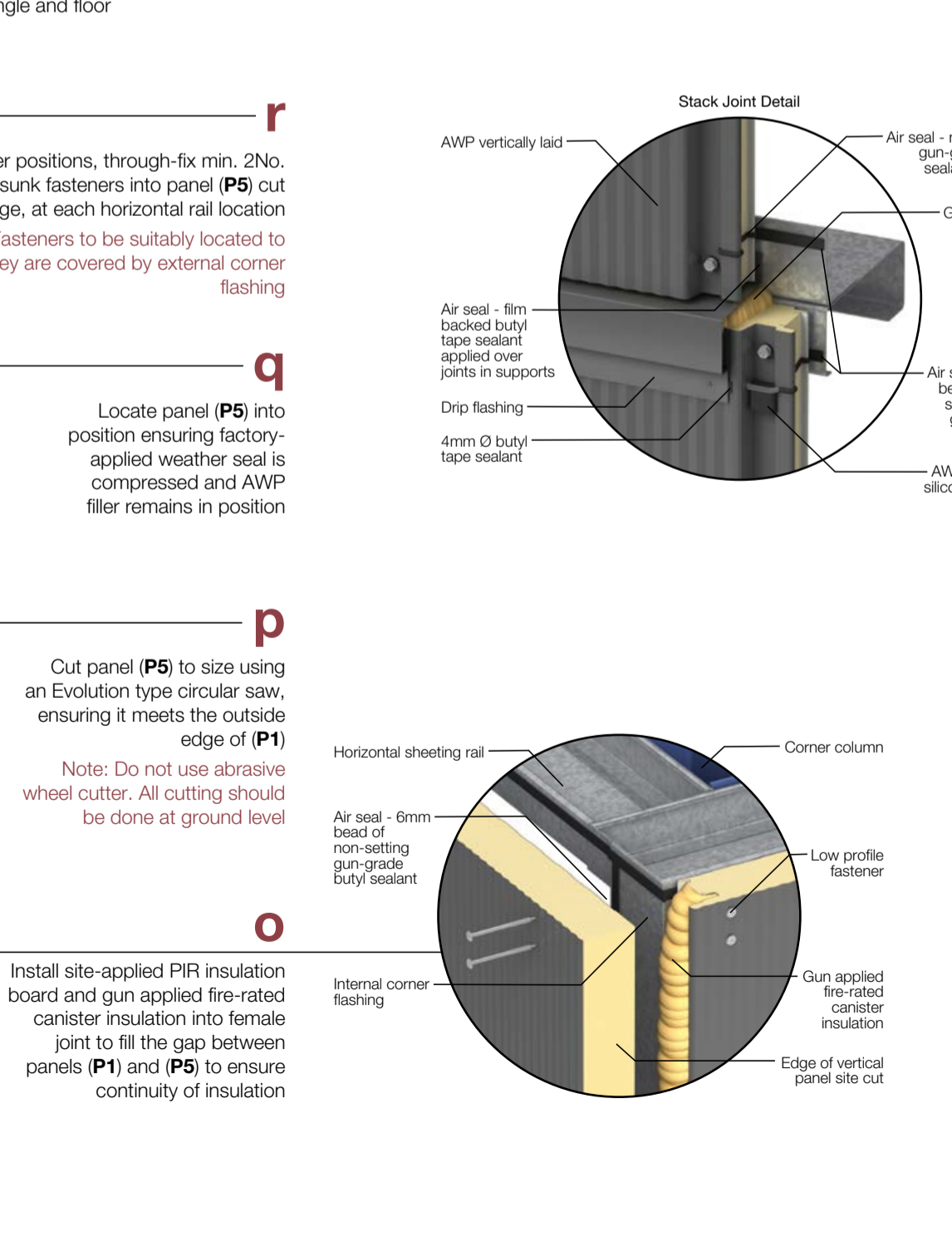
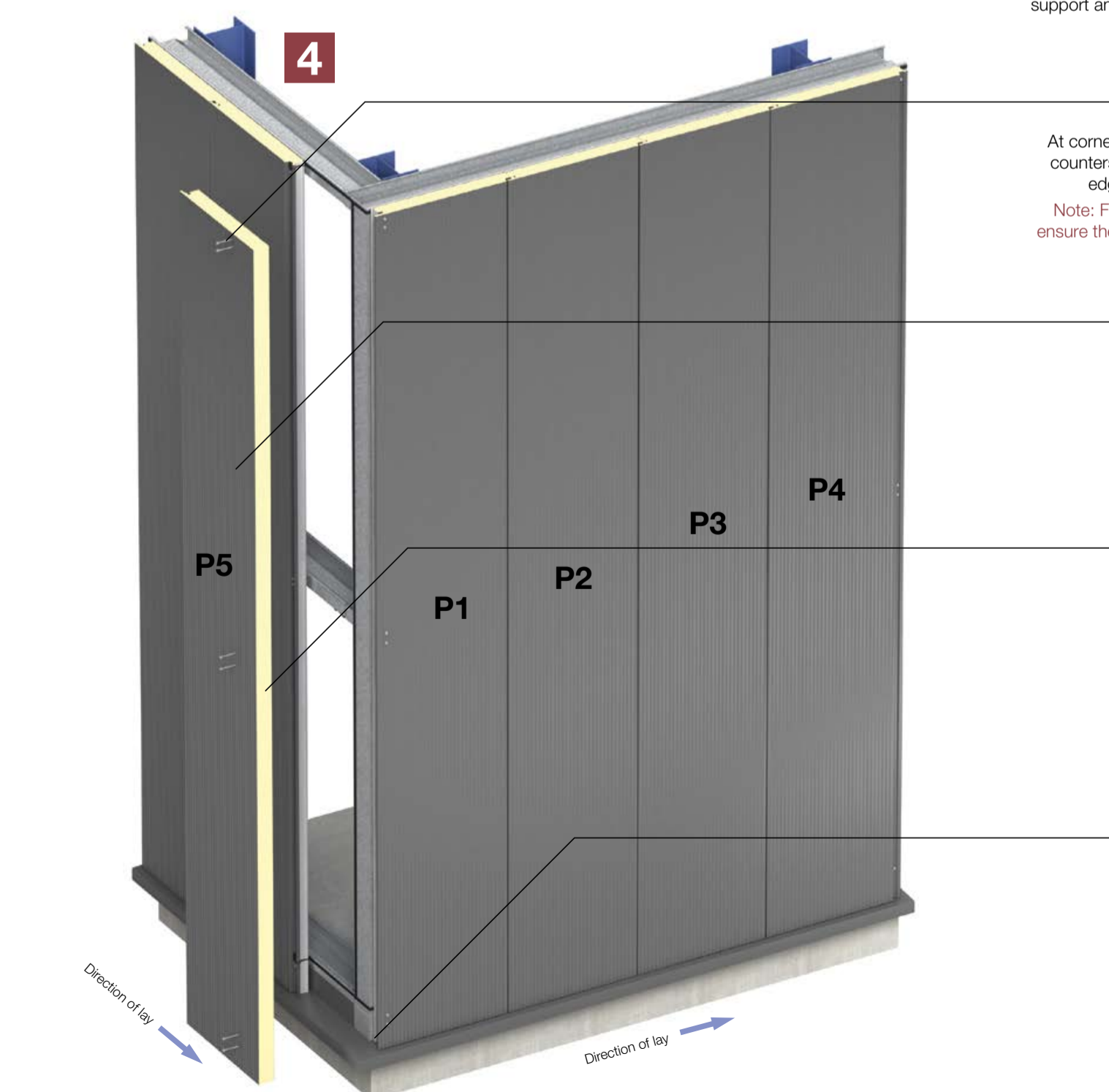
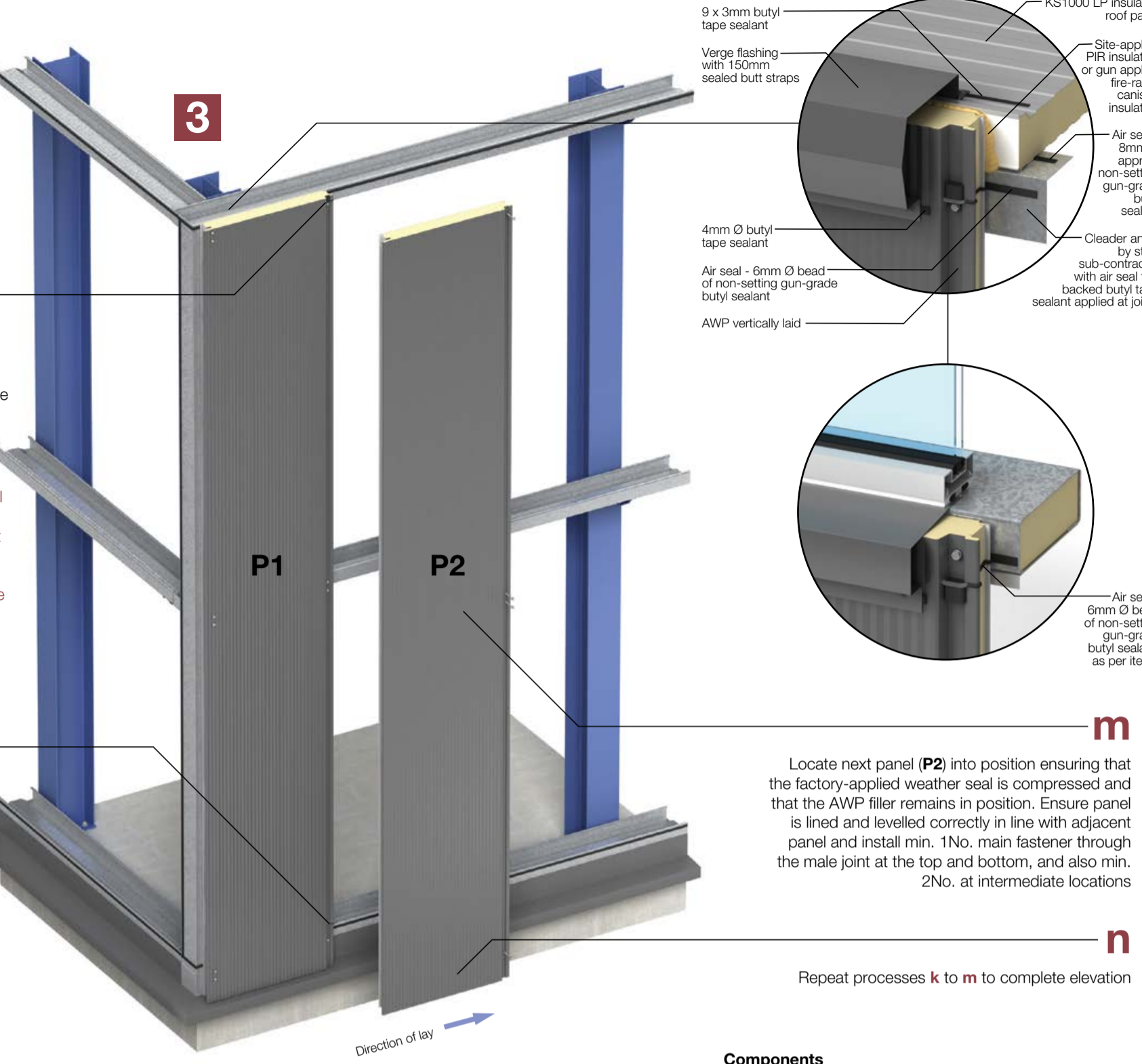
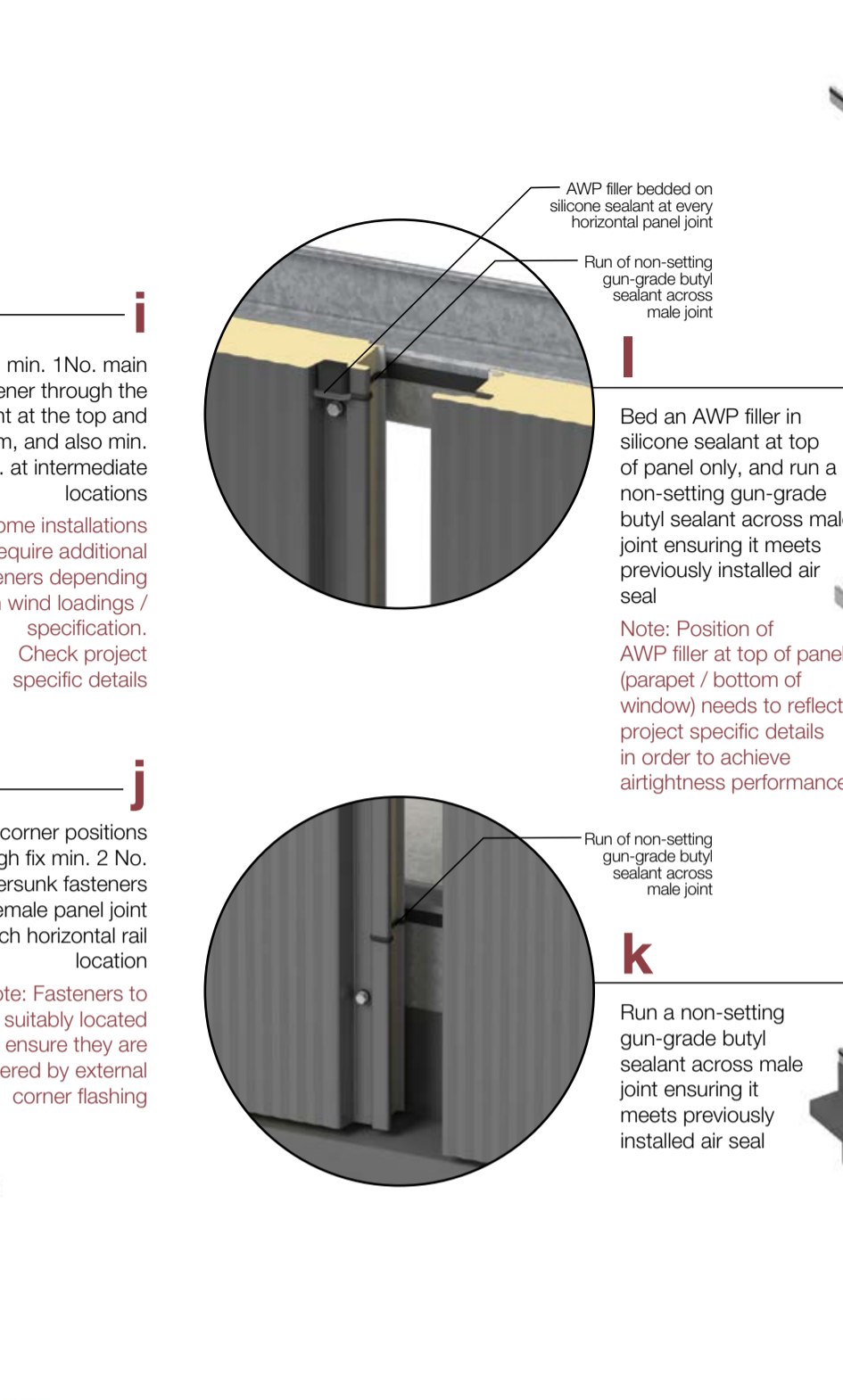
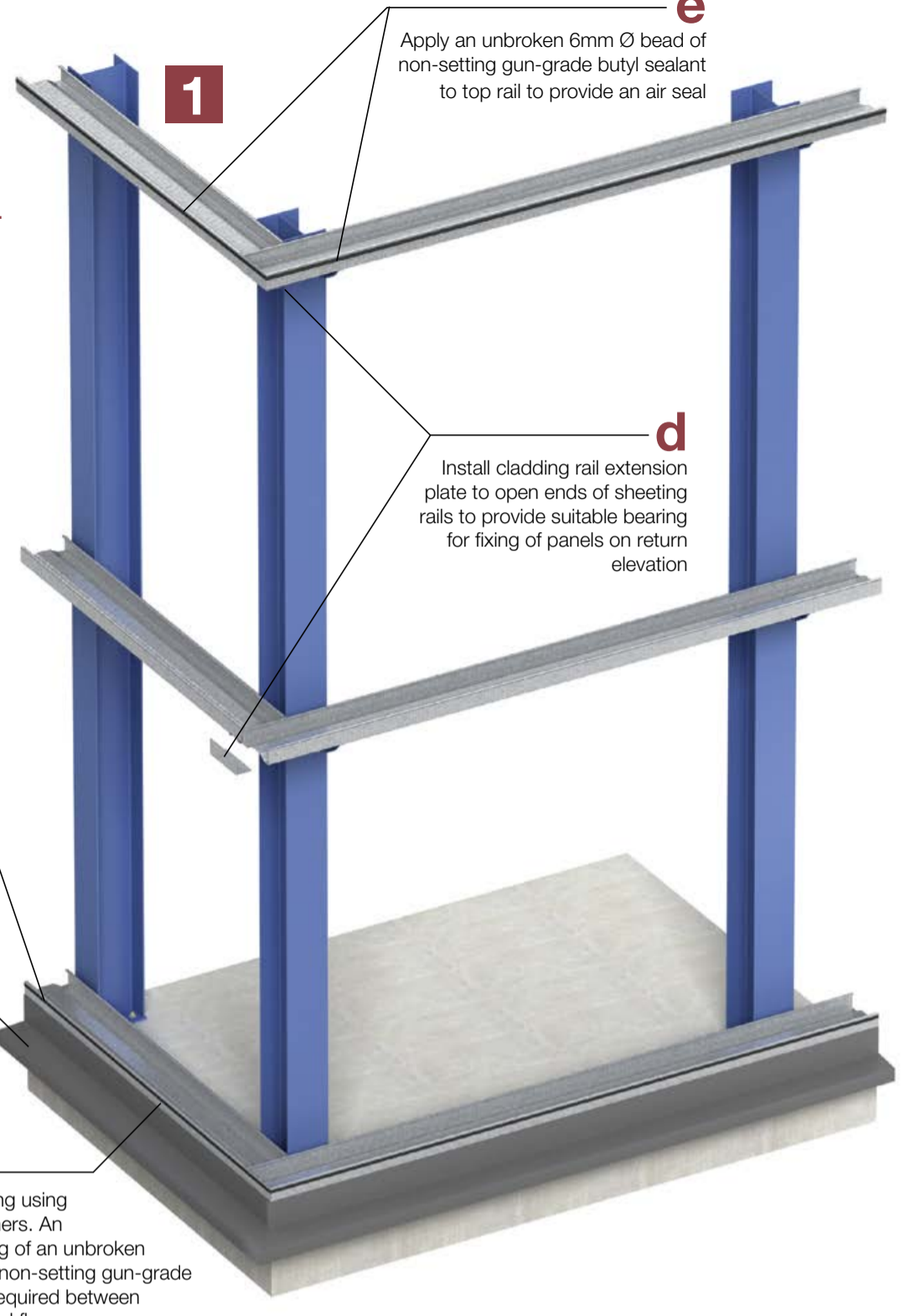
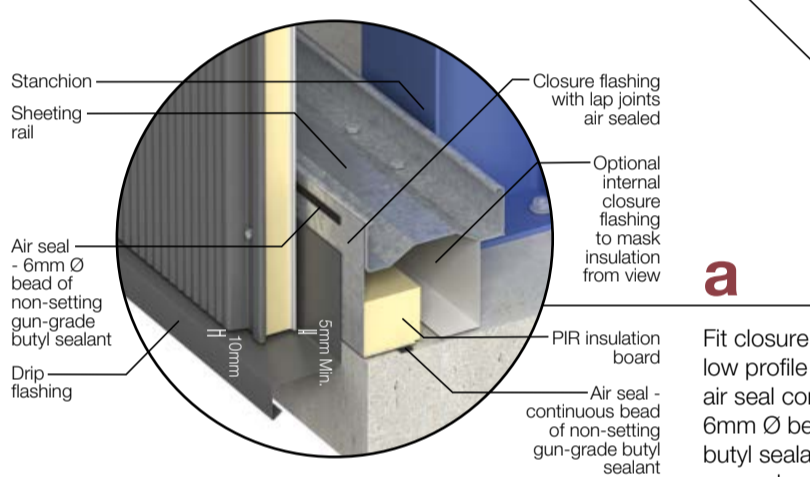

Components

Architectural Wall Panel

Primary / Main Fastener, Counter sunk main fastener, PIR insulation, Non-setting gun-grade butyl sealant, Silicone sealant

Closure flashing, Secondary / Stitching screw, Low profile fastener, External corner flashing

AWP filler, Butyl tape sealants, Drip flashing

Fire-rated canister insulation

This installation guide should be read in conjunction with the 'project specific' design drawings and method statements. Although this installation guide is deemed to be correct at the time of publication, Kingspan reserves the right to amend the information at any time in the future. Installation guides are available for most of Kingspan insulated roof and wall panels. Please call Kingspan Technical Services on: UK Tel: +44 (0)1352 716101 or Freephone: 0800 587 0090 IRL Tel: +353 (0) 42 9698529